

MOBIRO.

Pasul 6 (Montaj Balamale)

Se monteaza pe placa Front (6) si (7) cu placile (1) balamale (Ba) si (Bs) folosindu-se suruburi 4x18 (S8) - cate 4 / balama.

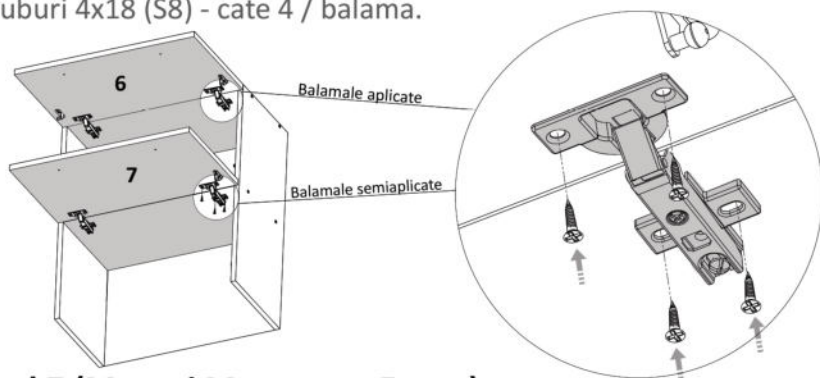

Pasul 7 (Montaj Manere pe Front)

Se monteaza pe placile Front (6) 2x maner mare folosindu-se suruburi M4x22 (Sm) - cate 2 / maner .

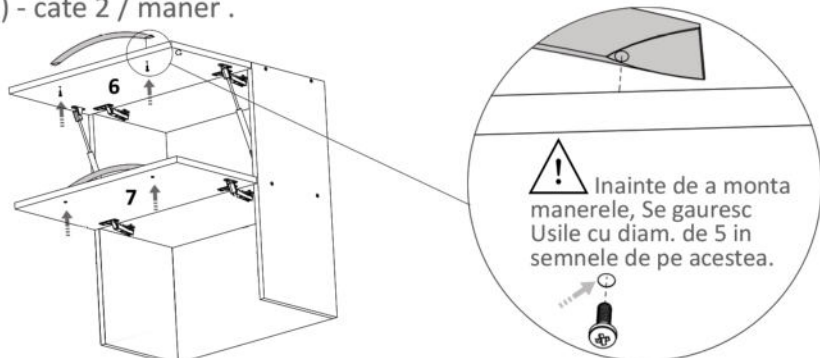

Pasul 8 (Montaj Piston)

Se monteaza pistonul (Ps) 2x piston prin introducerea acestuia in acesoriile (TL) si (Tu) pozitionate pe usi si laterale.

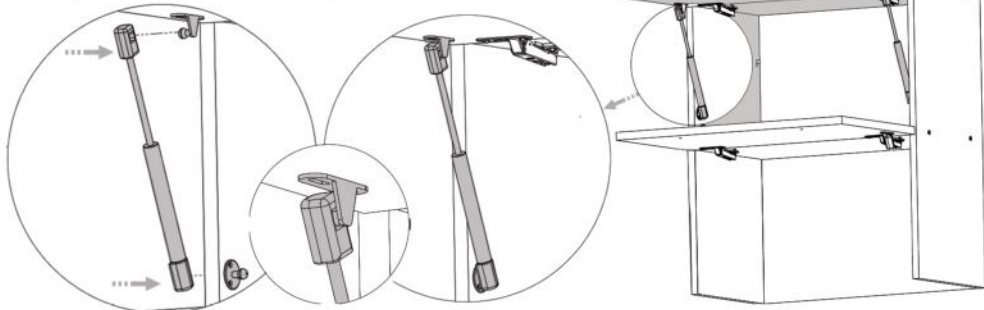

MOBIRO.

Instrucțiuni montaj: Corp Superior Orizontal Hota Extensibila 600 mm

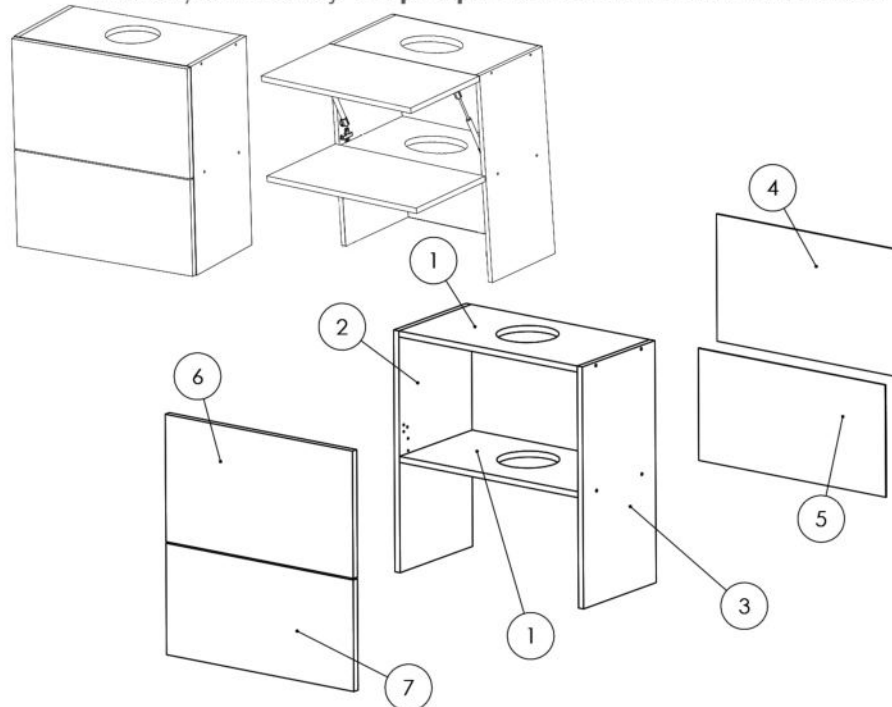

NR. REPER	DETALII	COD REPER	CANTITATE	BUC
1	PAL 568X308X16	POLITA FIXA / TAVAN	2	BUC
2	PAL660X308X16	LATERALA ST.	1	BUC
3	PAL660X308X16	LATERALA DR.	1	BUC
4	HDF 595X347X2.5	HDF MARE	1	BUC
5	HDF 595X307X2.5	HDF MIC	1	BUC
6	PAL 597X347X18	FRONT MARE	1	BUC
7	PAL 597X347X18	FRONT MIC	1	BUC

ATENȚIE: MONTAJUL NECORESPUNZĂTOR ATRAGE DUPĂ SINE PIERDEREA GARANȚIEI PRODUSULUI



Șurubelniță în cruce sau autofiletantă













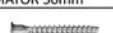

Este recomandat ca montajul să fie făcut de minim două persoane

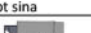

Un ciocan de dimensiune medie

MOBIRO.

Elemente feronerie:

CONFIRMATOR 50mm Co  8	SURUB 4X18 S8  16	SURUB 3.5X30 S6  12	SURUB M4X22 Sm  4
SAIBE TIP CUPA Sc  10	BALAMALE APLICATE Ba  2	SURUB 3.5X16 S3  12	Agatator pt sina Ag  2
CUIE Cu  40	BALAMALE SEMIAPPLICATE Bs  2	AMORTIZOR USA Am  1	PISTON Ps  2
Pasul 1 (Montaj Acesorii Laterale) Se prinde pe placa (2) - 1buc x (Am) + 1buc x (TL) iar pe placa (3) - 1buc x (TL) cu ajutorul suruburilor (S3) 3.5x16 ca si in imagine.	TALPA LATERALA PISTON TL  2	TALPA USA PISTON TU  2	

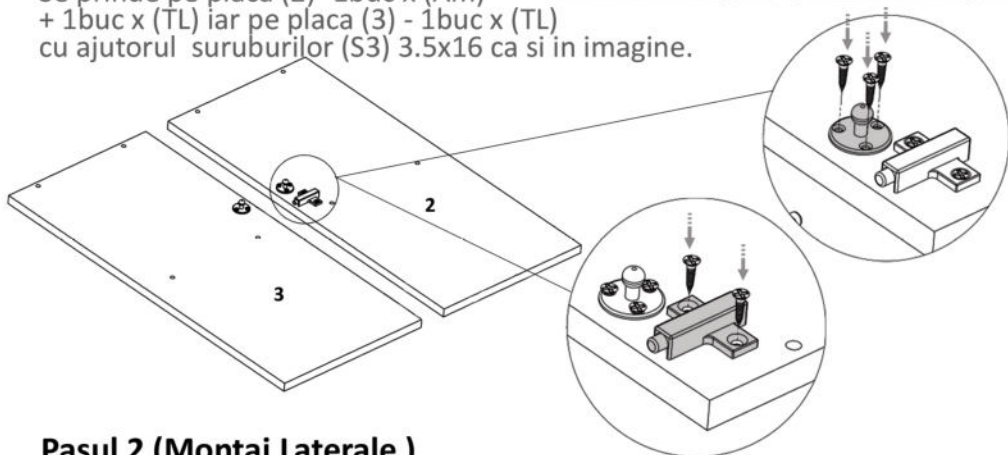

Pasul 2 (Montaj Laterale)

Se prinde placa (2) si (3) de placile (1) cu ajutorul celor 8 x Confirmatoare (Co)

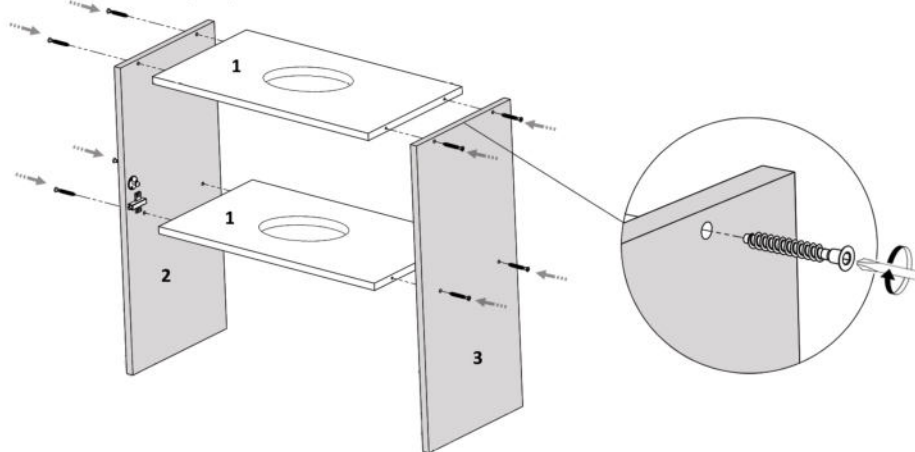

MOBIRO.

Pasul 3 (Montaj HDF)

Se masoara diagonalele sa fie in vinclu, dupa care se prinde HDF-ul (4) si (5) folosindu-se de ciocan cu ajutorul unor cuie (Cu)x40 buc, iar pe mijloc se folosesc saibe tip cupa (Sc) x10 buc.

 Se masoara diagonalele sa fie in vinclu inainte de a monta HDF-ul!

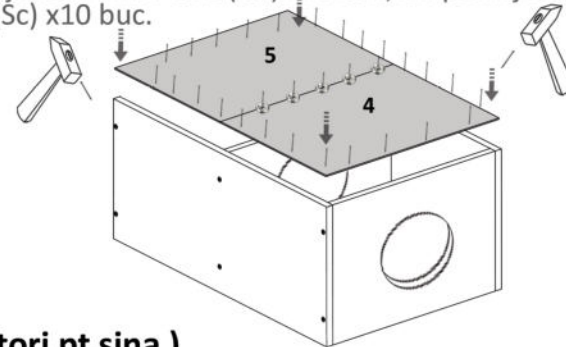

Pasul 4 (Montaj Agatatori pt sina)

Se monteaza pe laterale (2) si (3) 2x Agatator (Ag) folosindu-se suruburi 3.5x30 (S6) - cate 2 / agatator.

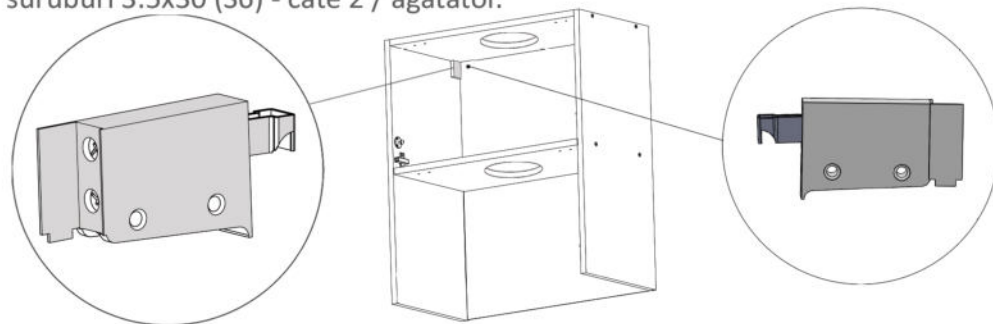

Pasul 5 (Montaj Accesorii pe Usa)

Se monteaza pe frontul (6) 2x (Tu), folosindu-se suruburi 3.5x16 (S3) - cate 2 / element.

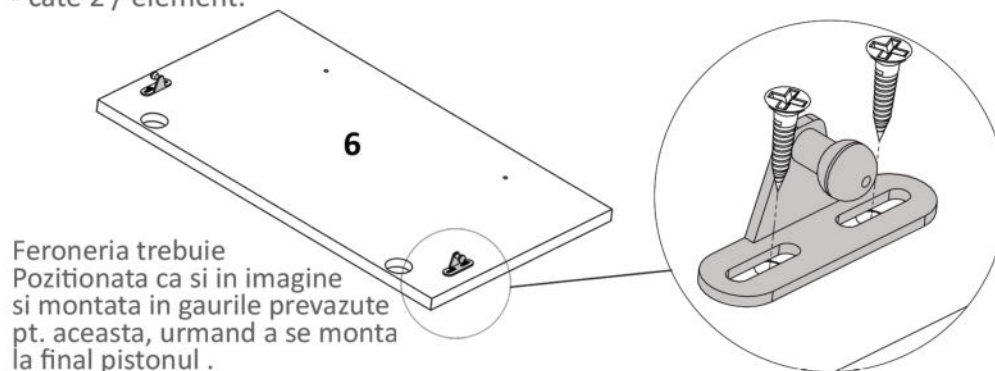

Feroneria trebuie Pozitionata ca si in imagine si montata in gaurile prevazute pt. aceasta, urmand a se monta la final pistonul .